

STRAIGHT BULKHEAD JACK FRONT MOUNT

R142.306.507

CLAMP TYPE - CABLE 2.6/75 S

Series : BNC 75

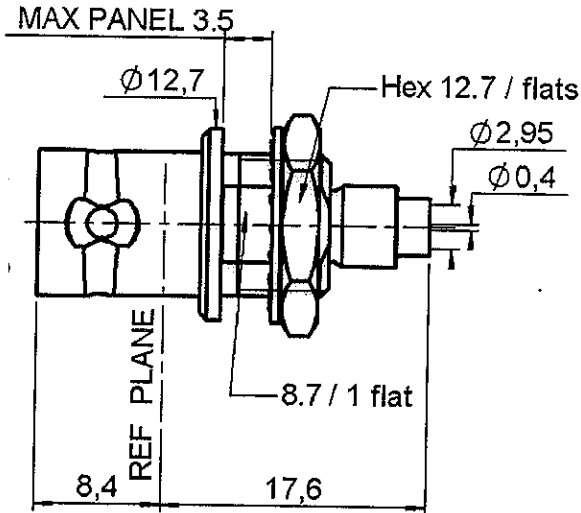

PANEL CUT OUT

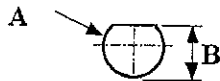

mm		
	Maxi	mini
A	9.6	9.7
B	8.85	8.75

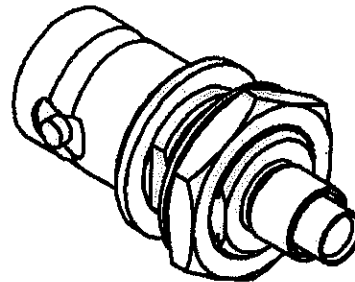
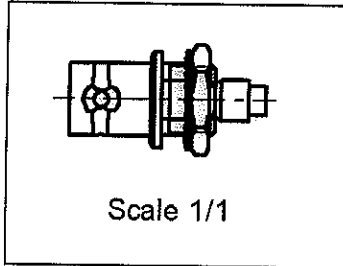

All dimensions are in mm.

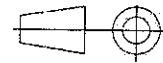

COMPONENTS	MATERIALS	PLATINGS (μm)
BODY	BRASS	BBR 2
CENTER CONTACT	BRASS	GOLD 2.5 OVER COPPER 2.5
OUTER CONTACT	-	-
INSULATOR	PTFE	-
GASKET	-	-
OTHERS PARTS	BRASS	BBR 2
.	.	.
.	.	.

Issue : 0044 A

In the effort to improve our products, we reserve the right to make changes judged to be necessary.



STRAIGHT BULKHEAD JACK FRONT MOUNT

R142.306.507

CLAMP TYPE - CABLE 2.6/75 S

Series : **BNC 75**

PACKAGING

Standard	Unit	Other
100	'W' option	Contact us

SPECIFICATION

ELECTRICAL CHARACTERISTICS

Impedance		75 Ω
Frequency		0-1.5 GHz
VSWR	1.30 +	0.000 x F(GHz) Maxi
Insertion loss		0.115 √F(GHz) dB Maxi
RF leakage	- (57 - F(GHz)) dB mini
Voltage rating		335 Veff Maxi
Dielectric withstanding voltage		1000 Veff mini
Insulation resistance		5000 MΩ mini

CABLE ASSEMBLY

Stripping	a	b	c	d	e	f
mm	3.00	10.0	0.00	0.00	5.00	15.0

Assembly instruction :

Recommended cable(s)
 RG 187
 RG 179

Cable retention

- pull off **40** N mini
 - torque **NA** N.cm

MECHANICAL CHARACTERISTICS

Center contact retention		
Axial force – Mating end	27	N mini
Axial force – Opposite end	27	N mini
Torque	NA	N.cm mini

Recommended torque		
Mating	NA	N.cm
Panel nut	250	N.cm
Clamp nut	NA	N.cm
√F clamp nut	0.000	mm

Mating life	500	Cycles mini
Weight	0.000	g

TOOLING

Part Number	Description	Hexagon
R282.223.000	CRIMPING TOOL	1.73
R282.211.000	CRIMPING TOOL	4.52
R282.235.011	CRIMPING DIES	1.73
R282.235.009	CRIMPING DIES	4.52
R282.293.000	CRIMPING TOOL	-

OTHERS CHARACTERISTICS

ENVIRONMENTAL

Operating temperature	-65/+165	°C
Hermetic seal	NA	Atm.cm3/s
Panel leakage	NA	

Issue : 0044 A

In the effort to improve our products, we reserve the right to make changes judged to be necessary.



RADIALL®

STRAIGHT BULKHEAD JACK FRONT MOUNT

R142.306.507

CLAMP TYPE - CABLE 2.6/75 S

Series : BNC 75

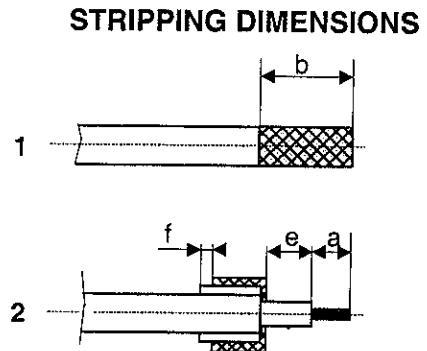
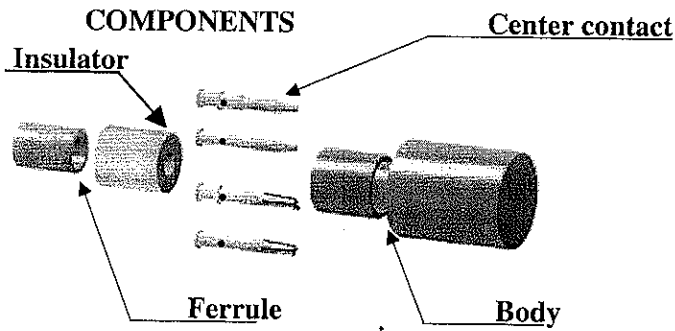

1

Strip the cable as shown in sketch 1.
Slide the ferrule until it bottoms against the sleeve.

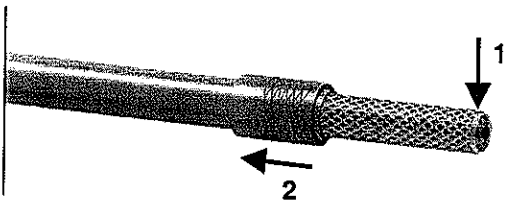

4

Slide the center contact on until it bottoms against the insulator back nut.
Solder or crimp the contact with crimping tool (see connector TDS)

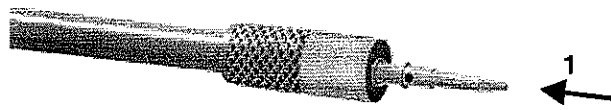

2

Fold the braid back.
Trim off the extra braid as shown in sketch 2.

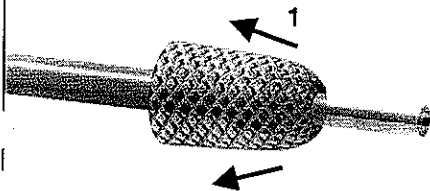

5

Mount the body onto the sub-assembly.



3

Trim the inner conductor as shown in sketch 2.
Slide insulator onto cable dielectric.

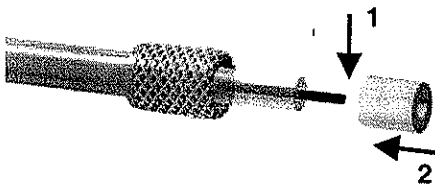

6

Crimp the body with crimping tool (see connector TDS).

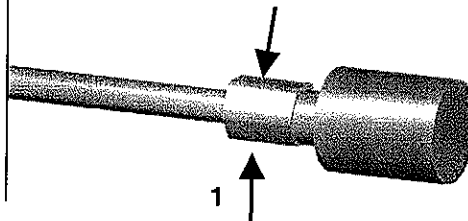

Issue : 0044 A

For the effort to improve our products, we reserve the right to make changes judged to be necessary.

